



Orbital Shower
Installation Model: Hatch

Quick installation guide

ORBITAL

Hatch

Please note: This document does not replace the installation manuals. For installation purposes, please use the respective Orbital Shower installation manuals.



Step. 1

- Prepare shower space
- Prepare path for piping

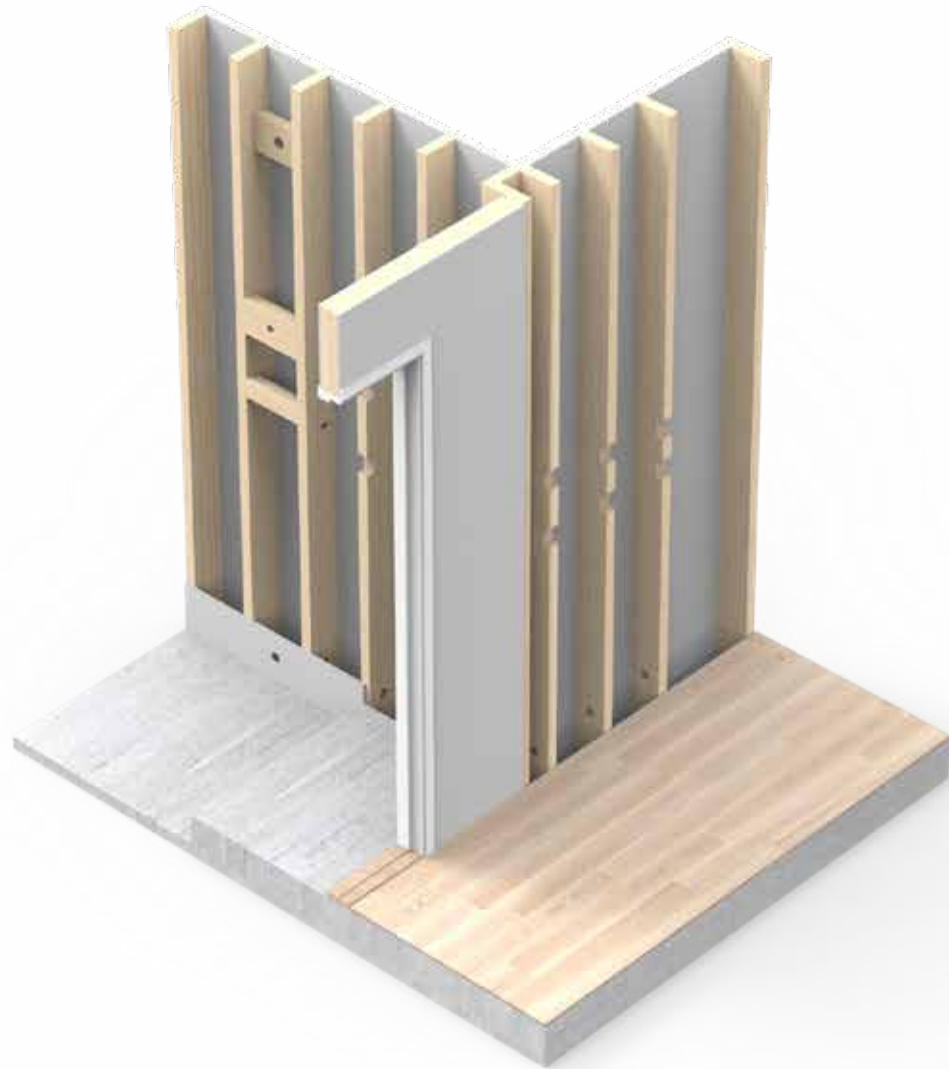

Step. 2

- Mount drain unit and sewage piping

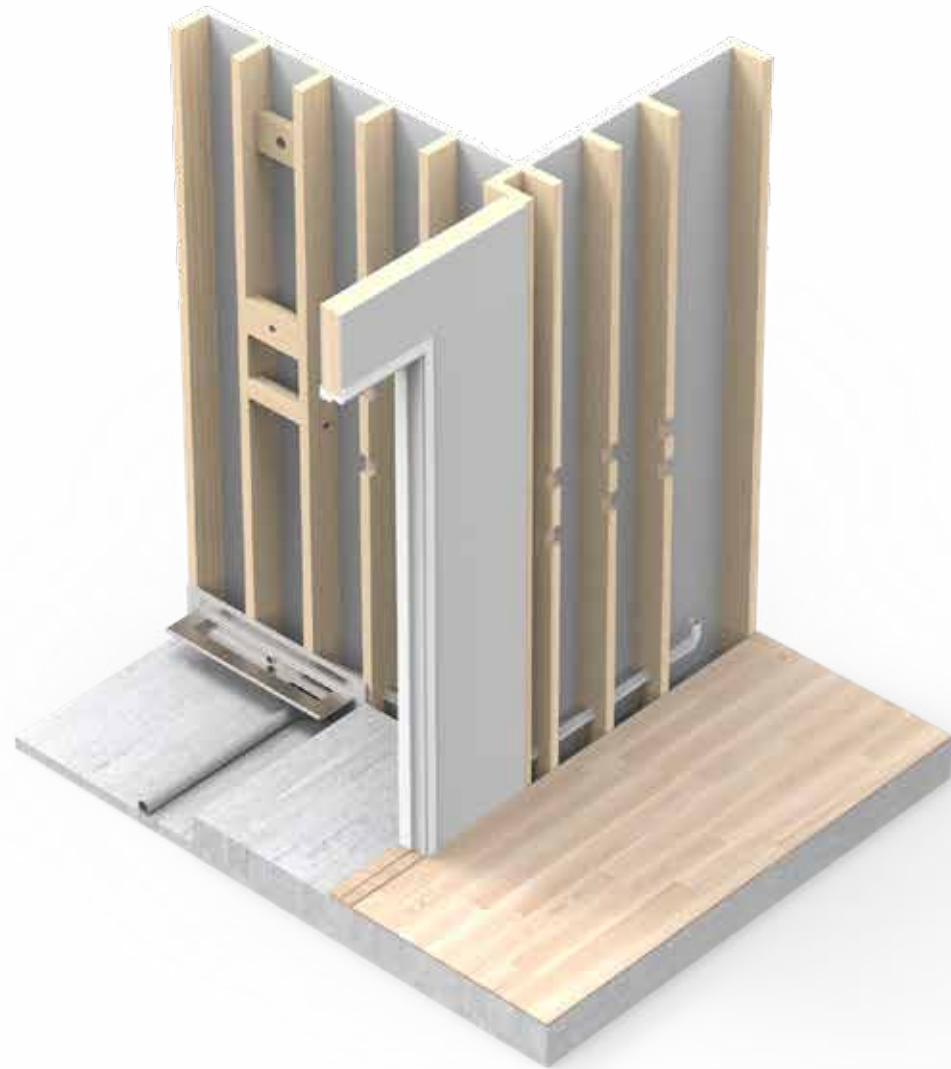

Step. 3

- Mount piping to shower heads, diverter and control dial
- Fixate the cabinet to the wooden beams



Step. 4

- Install incoming water (hot & cold)
- Install power supply



Step. 5

- Cover walls
- Raise floor



Step. 6

- Apply waterproof membrane

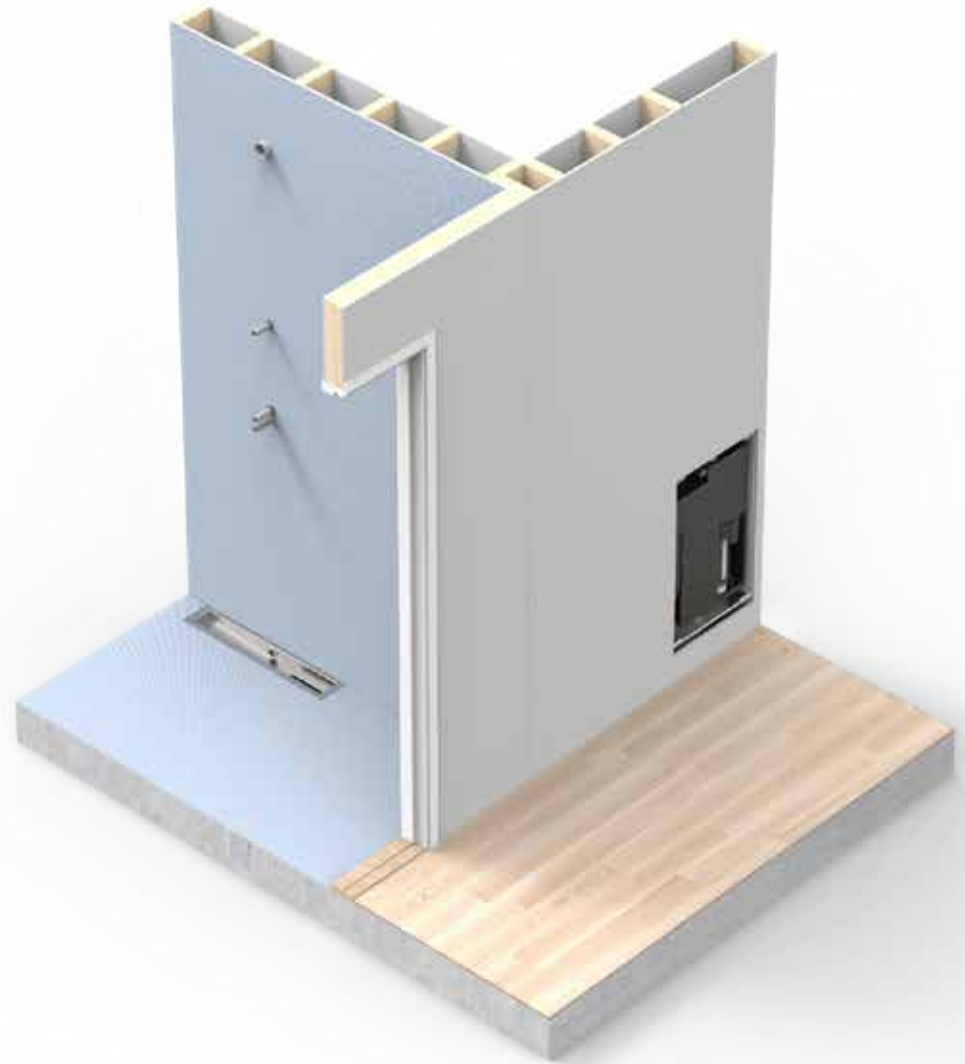

Step. 7

- Tile bathroom wall and floor
- Paint wall around the Orbital Shower Core
- Attach frame for cabinet

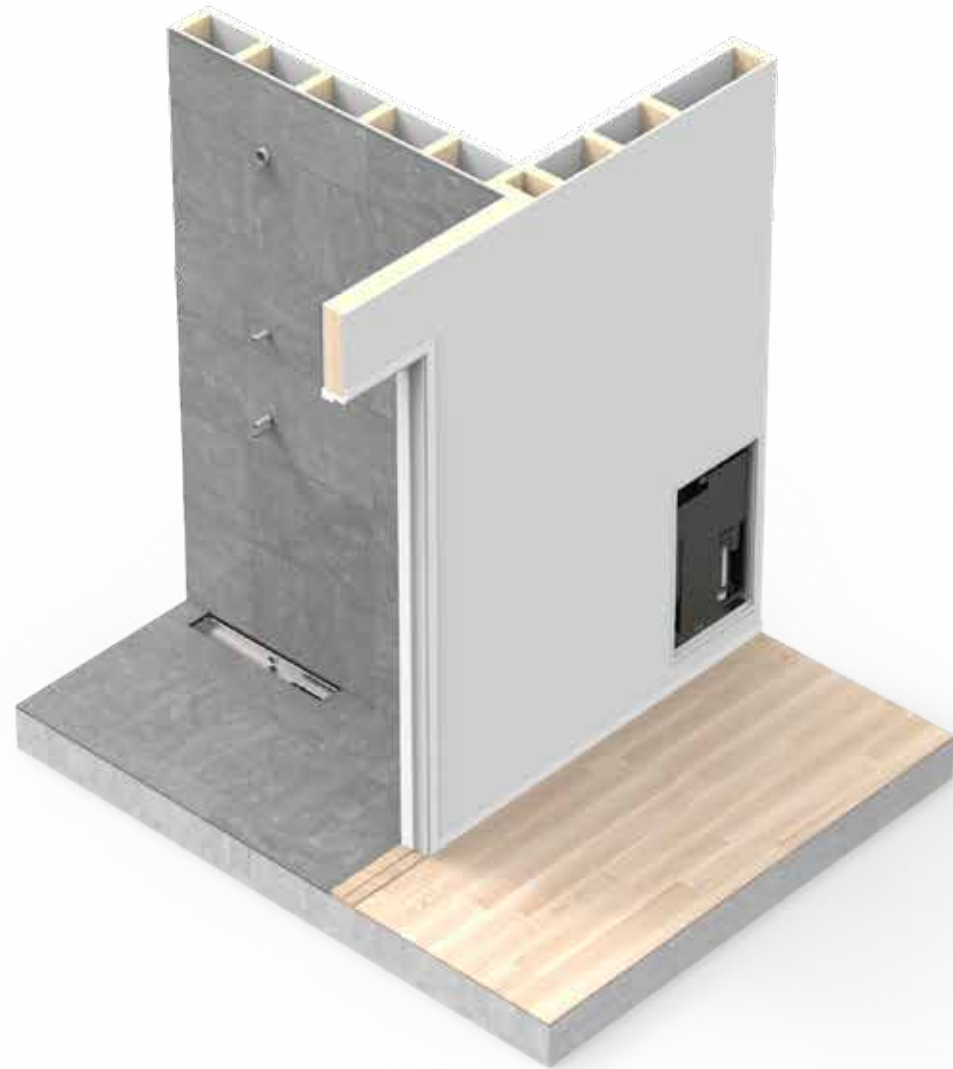

Step. 8

- Install smart sensor unit inside drain unit
- Mount door to the cabinet

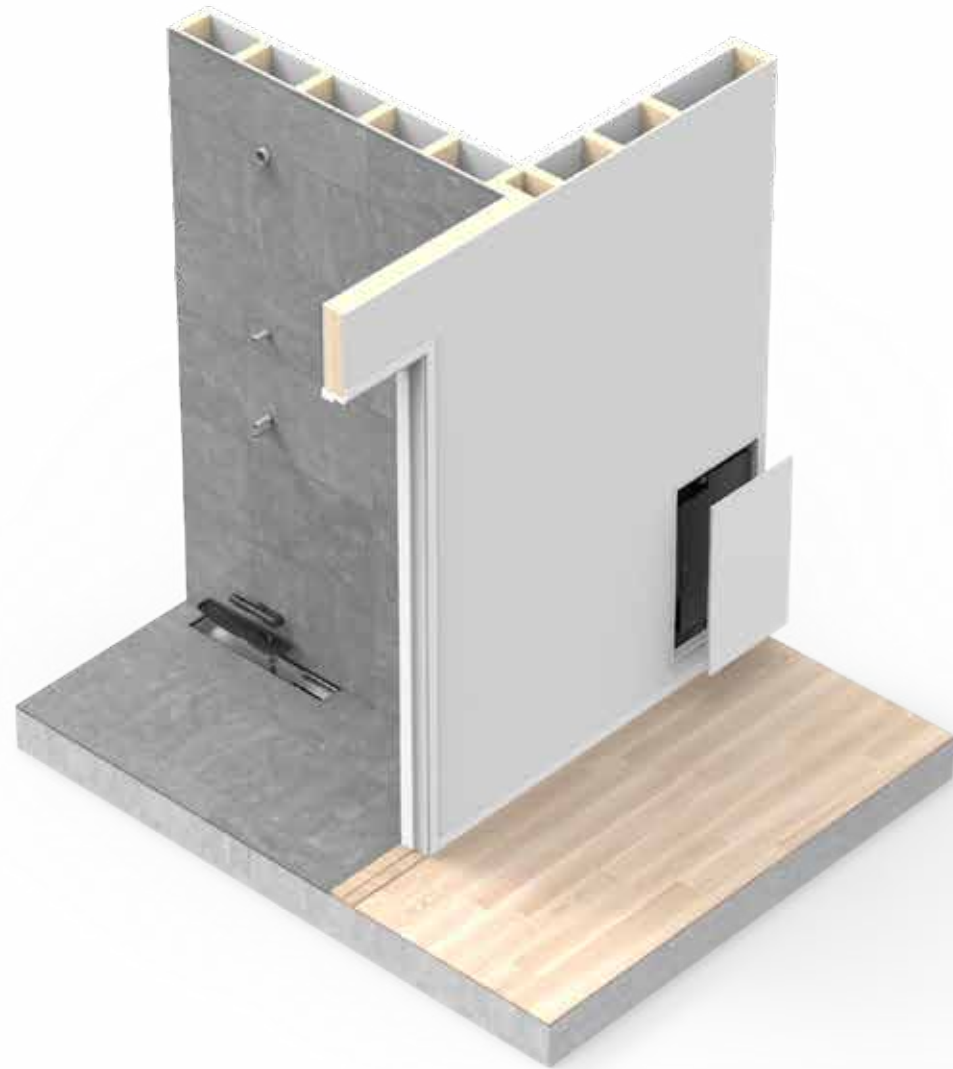

Step. 9

- Install shower heads, diverter and control dial

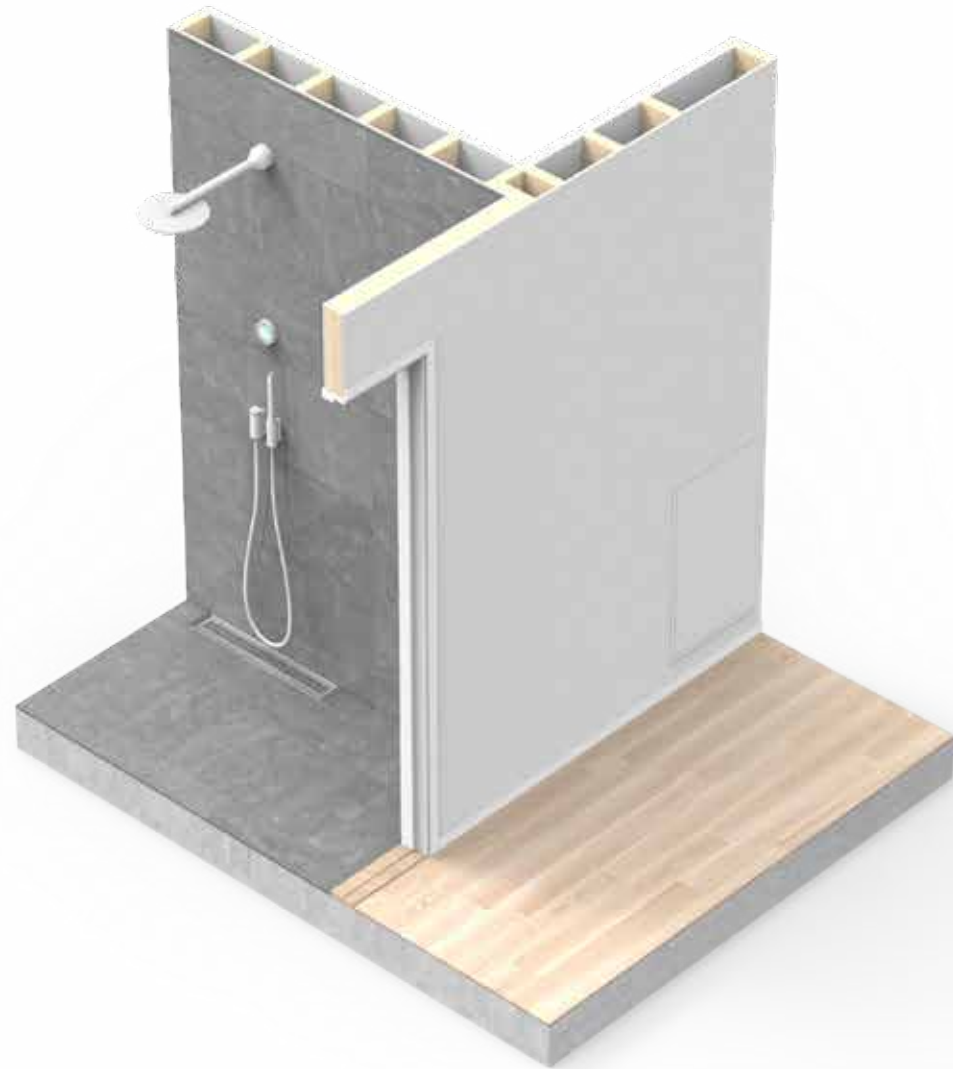

Installation completed

Please note: This document does not replace the installation manuals. For installation purposes, please use the respective Orbital Shower installation manuals.



www.orbital-systems.com



CERTIFIED SPACE TECHNOLOGY